

ALLDAY
& MILLER



Masefield Lane, Hayes, UB4 9AN
£340,000





Masefield Lane, Hayes, UB4 9AN

£340,000

- No Onward Chain
- Bungalow
- One Bedroom
- Front Garden
- Open Living/Dining Room
- Freehold
- Cul-De-Sac Location
- Potential To Extend (STPP)
- Rear Garden
- Garage

Description

This home presents a wonderful opportunity for those seeking a spacious home with great potential. The property features a bright and airy reception room, ideal for relaxation or entertaining guests, the double bedroom is equipped with a fitted wardrobe, providing ample storage space, a fitted kitchen and a bathroom is conveniently located, ensuring comfort and privacy.

One of the standout features of this property is the private rear garden, which is mainly laid to lawn. This outdoor space is perfect for dining and entertainment.

Situation

Masefield Lane a popular residential road in the heart of North Hayes. With easy access to a variety of local amenities including Lombardy Retail Park (within walking distance) and the Uxbridge Road with its array of shops and restaurants. Transport links here provide popular bus routes, the M4/A40 road links (providing access to London and The Home Counties), Heathrow Airport reachable in 10 minutes by car. The Elizabeth Line runs from Hayes & Harlington Station being just a short drive away making the commute into Central London a breeze. A number of highly rated schools including Yeading Primary School and Barnhill Secondary School also within close proximity.



Floor Plans

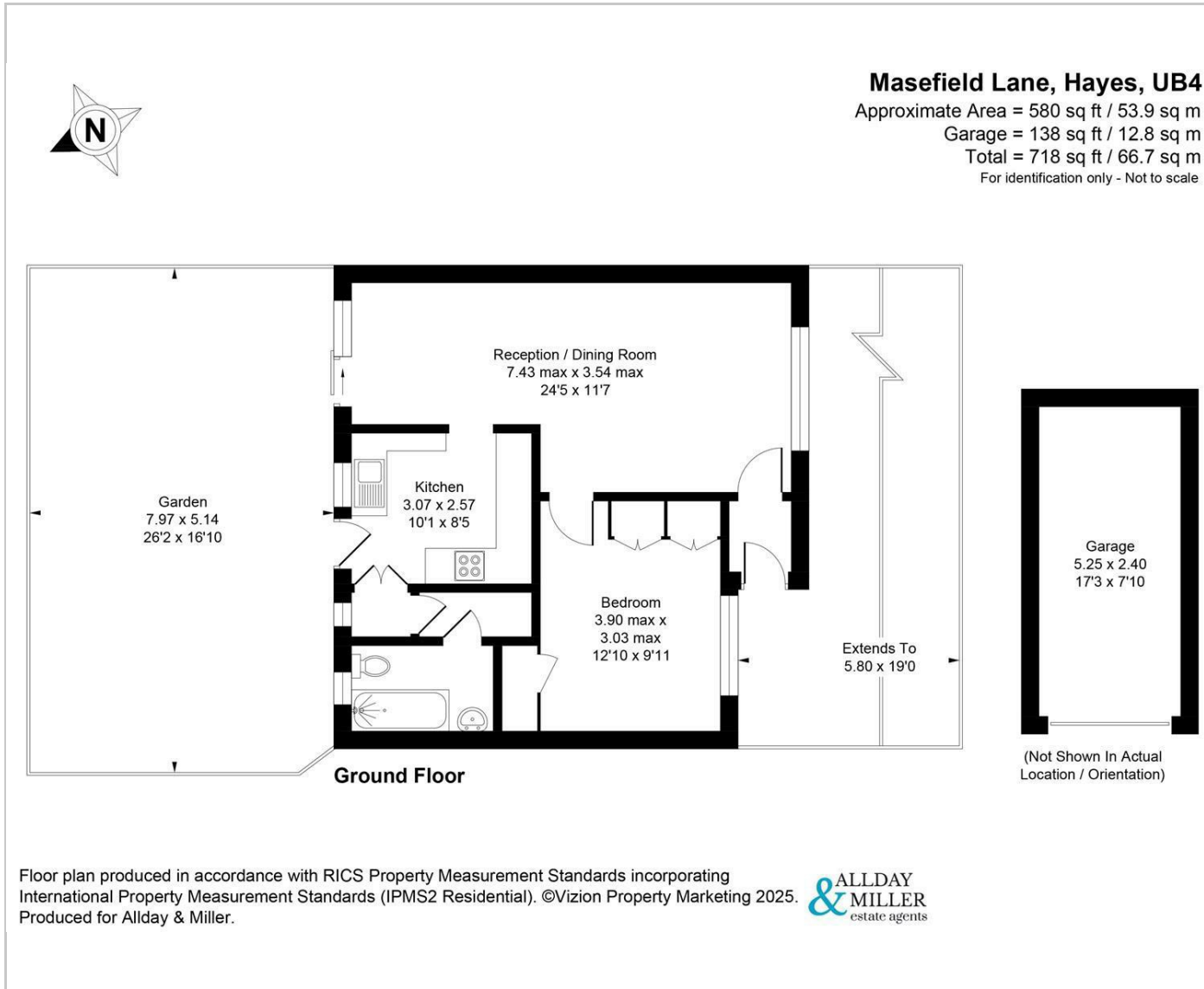

Area Map

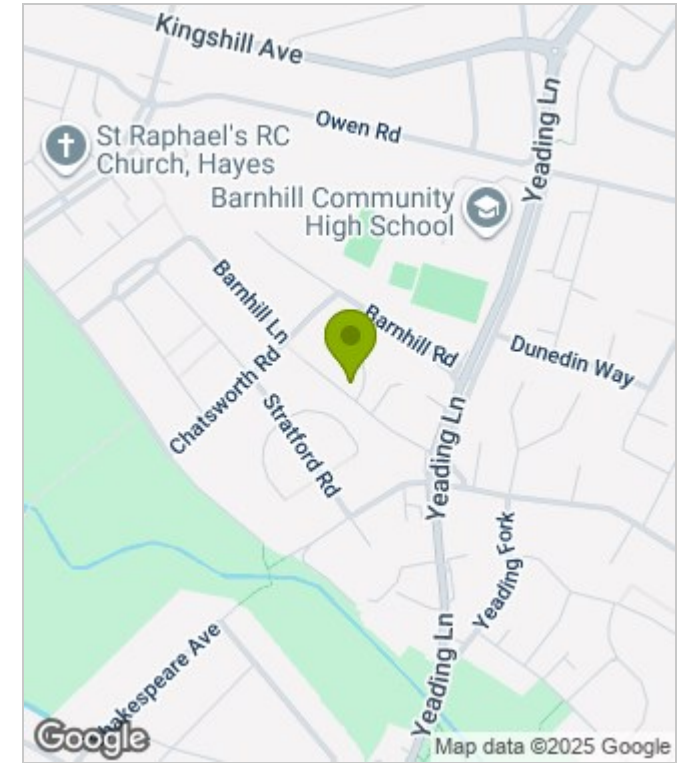

Energy Performance Graph

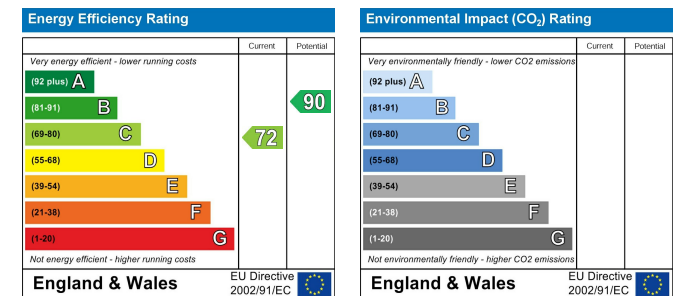

These particulars, whilst believed to be accurate are set out as a general outline only for guidance and do not constitute any part of an offer or contract. Intending purchasers should not rely on them as statements of representation of fact, but must satisfy themselves by inspection or otherwise as to their accuracy. No person in this firm's employment has the authority to make or give any representation or warranty in respect of the property.